

BU20

Unilumin



Rental



Sport



20mm

Football stadium screen

Features

- 
- By using advanced manufacturing technology, our LED lamps have wide viewing angle, high brightness and extraordinary color consistency and color resolution, so it is very ideal to make live broadcast to the audience in large stadium
 - Using Nichia or Cree brand of high brightness LED lamps to ensure the highest quality image display.
 - 16bits processing depth, 2000Hz refresh rate, showing a true HD image, and data will not be lost in transmission
 - Adopted backup system for power and controllers .thus, it can automatically or manually change to backup system when any parts of the system goes failure
 - Functional software can carry out muti-playing windows in one screen. It



BU20

can display image, text, time, live score etc..

- The cabinet is made from Aluminum, its weight is very light , good for installation ,movement and heat dissipation.
- The usage of intelligent power supply enable the input power can be switched between 110V and 240V without manual operation.
- EMI filter inside cabinet is to block the electricity surge and ensure the LED Display get the qualified power so as to make the LED Display working stably
- The fans inside cabinet are controlled by temperature sensor switch , the fans will be running only when the temperature reach the certain value. This way can save energy
- Signal and power cable are with waterproof flight connectors, it can be connected fast on site.
- The usage of soft mask on module and patent soft cover on cabinet top prevent players from getting injured
- Back support on cabinet is adjustable , which can adjust the screen to an ideal angle.

BU20 Parameters

1、Module



PARAMETERS	
Pixel Pitch	20mm
Optimum viewing distance	15-50m
Module resolution	16*8
Physical density	2500 Pixels/sqm.
Module size	320*160*25.5 (mm)
LED Encapsulation	DIP346 2R1G1B DIP346 1R1G1B
Driving Method	Virtual static Real static
Viewing angle	H: 110°; V:50°
Module power consumption	44w 25w
Module weight	915g 850g
Refresh rate	800-4000Hz
Brightness	≥6500nits

2、箱体

Cabinet size	W1280mm x H960mm x D160mm	Brightness	5000-8000nits
Cabinet material	Aluminum	Viewing angle	H: 110°; V:50°
Aspect ratio	4:6	Processing depth	16bits
Cabinet area	1.29sq.m	Life Time	> 100,000 hours
Cabinet resolution	64*48	MTBF	>5000 hours
Cabinet weight	72 kg/m ²	Working voltage	110-240 AC ± 10% 50-60Hz
Cabinet power consumption	1074w/m ² (virtual static) 610w/m ² (real static)	Working environment	-30°C - +50°C/10-90%RH

Cabinet array W*H	Cabinet quantity pcs	Size W*H (m)	Resolution W*H	Weight (kg)	Power consumption (W)
1X1	1	1.20*0.96	80*64	85	1250 (for example ,virtua)
2X1	2	2.40*0.96	160*64	170	2500 (for example ,virtua)
3X1	3	3.60*0.96	240*64	255	3750 (for example ,virtua)
4X1	4	4.80*0.96	320*64	340	5000 (for example ,virtua)

BU20

Cabinet photos

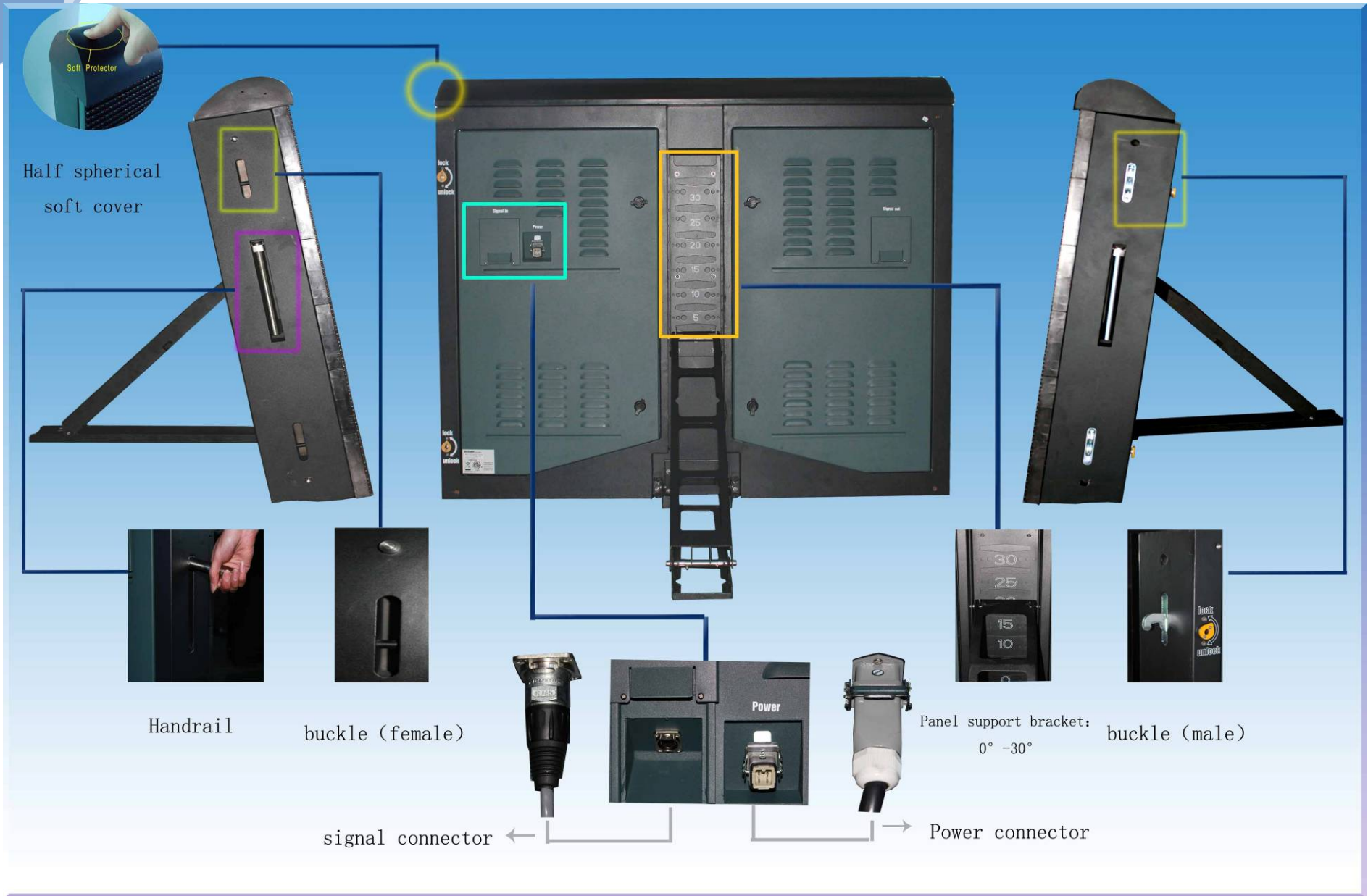

Half spherical soft cover



Handrail

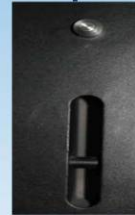

buckle (female)



signal connector



Power connector



Panel support bracket: 0° -30°



buckle (male)

支撐架
安裝步驟
Bracket
Installation



Installation

①



⑥

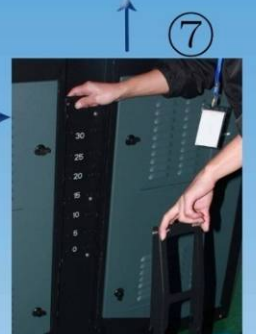

⑦



②



③



④



⑤



BU12



Cabinet mechanical drawing

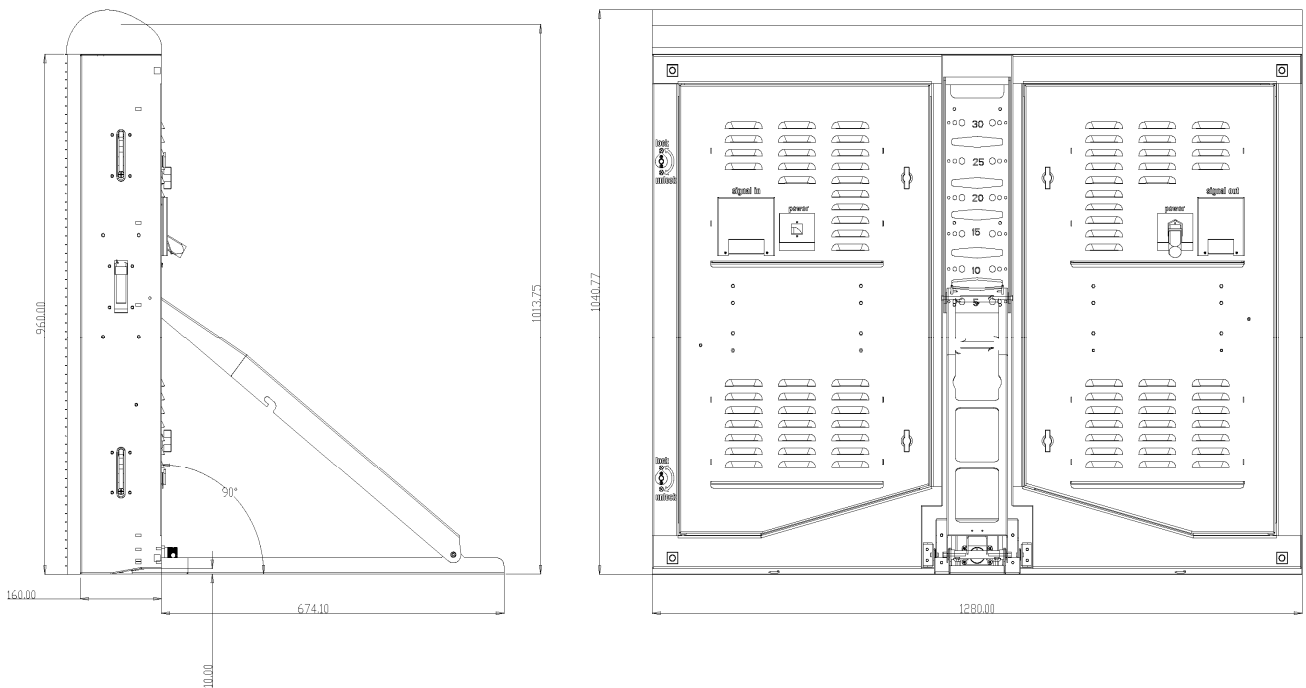

BU12

Unilumin

System/Power connection diagram



BU12
System control box



Weight: 78kgs



← optional

Video processor VSP618



← optional

DVD player



← optional

Audio/Video Matrix

→ necessary

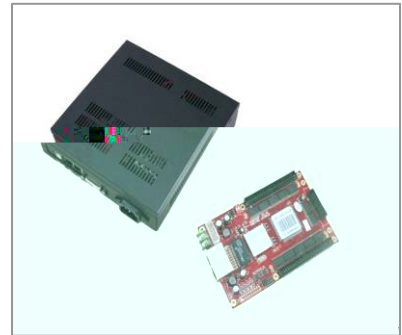

Sending card /receiving card

→ necessary



Computer

→ necessary



Monitor

Overall cabling diagram

